



EXPEDITIONS



GALÁPAGOS

2025-2027 VOYAGES | [EXPEDITIONS.COM](https://www.expeditions.com)



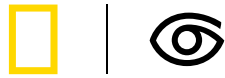

CONTENTS

Experience Galápagos From a New Perspective	4
On Expedition in Galápagos: A Day in the Life	6
The Ultimate Galápagos Expedition Fleet	8
A Travel Experience Five Decades in the Making	12
National Geographic Global Explorers Program	14
Galápagos Map	16
Itinerary: Exploring Galápagos	18
Itinerary: Galápagos by Catamaran: An Intimate Voyage	19
Itinerary: Galápagos Escape: A 7- or 8-Day Voyage	20
Itinerary: Peru and Galápagos Escape	21
Back-to-Back Expeditions	22
Extend Your Experience	24
Ships	28
Galápagos Fleet Guide	32
Special Offers	34
Reservation Information	35

Cover photo: Blue-footed booby, Galápagos. @ Jeff Litton

Left: Guests adventure by Zodiac in the rocky arch at Kicker Rock, San Cristobal Island. @ Ralph Lee Hopkins

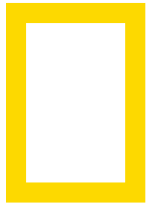

EXPERIENCE GALÁPAGOS FROM A NEW PERSPECTIVE

WITH NATIONAL GEOGRAPHIC-LINDBLAD EXPEDITIONS

For more than 20 years, National Geographic and Lindblad Expeditions have collaborated to connect curious travelers with transformative experiences. These pioneers defined modern expedition travel, and now they are setting new standards with immersive and illuminating voyages, where every element of the experience inspires genuine discovery.

TRAVEL WITH A WORLD-CLASS TEAM

Voyages are led by passionate expedition teams—naturalists, photographers and cultural specialists who are explorers at heart. National Geographic Experts join select departures, inspiring new perspectives on your surroundings.



TAKE GREAT PHOTOS WITH THE PROS

National Geographic photographers have spent decades traveling the globe, capturing the world's most impactful images. They join select Galápagos expeditions, and a National Geographic certified photo instructor accompanies every departure, helping travelers hone their camera skills in captivating places.

EXPLORE YOUR WAY EVERY DAY

Itineraries feature a range of immersive activities that bring you into the pages of *National Geographic Magazine*, from snorkeling with curious sea lions to hiking amid colonies of blue-footed boobies. Each expedition offers excursions for every skill level so that you can explore your way—and at your own pace—every day.

REVEALING UNDERSEA WONDERS

An undersea specialist brings Galápagos marine wonders to the surface by capturing underwater footage of fascinating sea creatures and geological features. During nightly recaps, the specialist interprets images from the day's dive, offering insights integral to the story of Galápagos.

EXPEDITIONS THAT GIVE BACK

Travel with peace of mind knowing that every voyage gives back to protect the natural and cultural heritage of Galápagos through the Lindblad Expeditions-National Geographic Fund. To date, the fund has invested more than \$24 million to projects aimed at preserving the world's oceans, restoring critical marine and coastal habitats and fostering environmental stewardship.

All In

Activities and excursions are always included in the voyage price unless otherwise noted.



A DAY IN GALÁPAGOS

The animals of the Galápagos are unusual, unafraid and overwhelmingly endemic, and observing them with knowledgeable guides is the hallmark of your experience.



Early Start: Rise and Roam

Greet the day with a stretch session on the beach, practicing sun salutations with your wellness specialist, or head to the bow to look for early-morning wildlife activity alongside expert naturalists. Young travelers in the National Geographic Global Explorers program can begin recording the day's sightings in their official field notebooks.

A Farm-to-Table Breakfast

A fresh breakfast awaits in the dining room: bespoke omelets, a rainbow of fruits and juices, Galápagos-grown coffee and more—much of it sourced from local farms as part of the fleet's pioneering farm-to-table program.



Morning Excursion: Dive In

Snorkel or scuba dive* in the Galápagos Marine Reserve, home to an array of captivating creatures: sea lions, technicolor fish, marine iguanas and feeding penguins. Prefer to stay dry? Join a naturalist in a Zodiac or glass-bottom boat for a cruise through a shallow bay to observe marine life at water level.



Talks and Photo Tips

Back on board, join a naturalist or National Geographic certified photo instructor in the lounge for an engaging talk or a smart-phone photo tips session. Or head to the fitness center, relax in a hammock on deck or read up on Charles Darwin in the library.

A Local Lunch

Every meal on your voyage is fresh, sustainable and locally sourced—but one lunch stands out: a special Ecuadorian feast, with dishes from the country’s coasts, highlands and islands. The wild-caught fish in coconut milk is a highlight.



Afternoon Excursion: Paddle, Hike or Walk

Paddle a kayak or stand-up paddleboard along the coast for a closer look at fascinating volcanic features and textures. Or head ashore with your camera in hand for a birding walk. Sightings depend on the island—but keep a lookout for or waved albatrosses performing courtship dances and flightless cormorants diving for fish.



Ready for Recap

Meet in the lounge over drinks and hors d’oeuvres, and settle in for the daily recap, featuring presentations and photo slideshows on the day’s adventures and a preview of tomorrow’s activities. The fleet often hosts researchers, national park personnel and other people living and working in the Galápagos, and one of these special guests may be tonight’s featured speaker.



Seeing Stars

After a delicious dinner, bring your binoculars to the top deck for a naturalist-led stargazing session. You’ll have the rare opportunity to see the Big Dipper and Southern Cross at the same time—a phenomenon that only happens at the Equator.

**Scuba diving is available for experienced divers on select departures and at an additional cost. Diving excursions are run by a local operator.*



THE ULTIMATE GALÁPAGOS EXPEDITION FLEET

Beginning early this year, National Geographic-Lindblad Expeditions will sail four exceptional vessels in the Galápagos year-round, each with a unique onboard experience. Together, they offer a full spectrum of travel options, whether you wish to voyage solo or with family—or charter an entire ship for a private experience.

National Geographic Delfina

Specially designed for cruising the islands, this sleek, luxury catamaran is the most intimate ship in the Galápagos fleet, accommodating 16 guests in eight spacious staterooms. Each cabin has a private balcony or access to an expansive wooden deck, and amenities include open-air dining and a top deck hot tub.

National Geographic Delfina is ideal for private voyages; when you charter her just for your family or group, you enjoy all the benefits of the National Geographic-Lindblad Expeditions Galápagos experience, including access to the National Geographic Global Explorers program for young travelers.



Learn More

Explore the sleek, intimate spaces of this luxury catamaran.



Clockwise from top: Observation deck with Whirlpool hot tub; main deck with intimate dining; Category 4 stateroom.





National Geographic Islander II

National Geographic Islander II is an intrepid expedition vessel with the spirit and soul of a private yacht. She is outfitted with 26 comfortable staterooms and suites as well as sleek shared spaces that emphasize indoor-outdoor living.

Al fresco dining and an open-air observation deck and plunge pool give you the exhilarating feeling of being out on the water with all the comfort of graciously appointed living spaces. Every detail of the onboard experience—from the regional artwork to the locally sourced meals—immerses you in your Ecuadorian surroundings, while special amenities, including a well-equipped marina and a dedicated science hub, take your Galápagos explorations to a new level.



Above: Cove lounge; Cove lounge bar; outdoor café.



Take a Virtual Tour

Fly through the ship's elegant decks and staterooms on a virtual tour unlike any other.

National Geographic Gemini

Launched in 2001 from the same shipyard as *National Geographic Orion*, the highly maneuverable 48-guest *National Geographic Gemini* is geared for discovery, with Zodiacs, a glass-bottom boat, kayaks and paddleboards and snorkeling gear for each guest. She offers a variety of outward-facing cabin configurations—a mix of singles, doubles, triples and connecting cabins and suites, including the largest suites in the Galápagos fleet.

Enjoy the outdoors on the upper deck, where a hot tub, fitness center and spa meet your wellness needs. The outdoor café and indoor dining room accommodate all guests, and the lounge features a large bar and well-stocked library.



[Learn More](#)

Read about this fully equipped expedition ship and her wide array of accommodations.



Clockwise from top: Category 7 suite with two separate balconies; lounge with full service bar and facilities for films, slideshows and presentations; dining room.





National Geographic Endeavour II

Born in Patagonia, *National Geographic Endeavour II* was repositioned to the Galápagos following a stem-to-stern refit that perfectly accommodates the National Geographic-Lindblad Expeditions style of travel. She accommodates just 96 guests in 52 thoughtfully appointed cabins and is comfortable and welcoming to solos, groups and kids of all ages.

National Geographic Endeavour II is exceptionally nimble, with a shallow draft for up-close discovery and exceptional viewing from all public spaces. Her exploration tools include a glass-bottom boat, underwater cameras and video microscope as well as kayaks, paddleboards and dedicated snorkeling gear for each guest.



Learn More

See more details about this purpose-built expedition ship.



Clockwise from top: Library, Bridge deck; lounge with full-service bar and state-of-the art facilities for films, slideshows and presentations; observation deck.

A TRAVEL EXPERIENCE FIVE DECADES IN THE MAKING

In the 1960s, the Galápagos Islands were known around the world as the inspiration for Charles Darwin's theory of evolution, but the destination had only been seen by a privileged few. Explorer Lars-Eric Lindblad was lured by the prospect of witnessing Darwin's famous finches and other creatures that illustrate the power of evolution in isolation.

Astounded by what he found there, Lindblad recognized the potential for tourism in the archipelago and was compelled to share its wonders—and so, he took the first international tourists to Galápagos in 1967. He had a vision for travel that was grounded in sustainability, long before the green travel movement was mainstream.



Lars-Eric Lindblad exploring the Galápagos in 1968.

During these early days, Lindblad engaged local scientists, conservationists and residents whose lives and livelihoods were intertwined with their wild surroundings. They helped establish tenets for responsible travel, and today, Galapagueños serve as naturalist guides, guest speakers and hosts for island excursions, providing the most authentic experience possible.

“ Mr. Lindblad single-handedly brought international tourism to Galápagos, and he insisted on regulation to prevent damage to the islands. He made it so we specialize in something—a love for nature. ”

— GUSTAVO VALLEJO, JOURNALIST





Clockwise from top left: A guest kayaks along a rocky Galápagos coastline; chefs from National Geographic Endeavour II source vegetables from a local farm; the Charles Darwin Research Station; naturalist and guests exploring by Zodiac; Galápagos researchers track a deep-sea camera.

Many of the responsible tourism guidelines Lindblad helped establish are still followed by operators today, and National Geographic-Lindblad Expeditions continues to strengthen its commitment to conservation. With the help of guests, more than \$10 million have been contributed to the preservation of Galápagos habitats and communities.

With the recent addition of two ships to the Galápagos fleet—*National Geographic Gemini* and *National Geographic Delfina*—National Geographic-Lindblad Expeditions

now provides an array of options so travelers can choose their ideal Galápagos experience.

These are voyages born from the relationships built and knowledge gained over 50 years of exploration—and they celebrate every part of this special place, from the wild sea to the stars above and the volcanic landscapes and vibrant communities in between. Whatever experience you seek in the Galápagos, you'll find it aboard the fleet, where you'll be privy to the best-kept secrets of this world-renowned destination.



NATIONAL GEOGRAPHIC GLOBAL EXPLORERS PROGRAM

NURTURE THEIR PASSION FOR EXPLORATION

Something magical happens when you introduce a child to the wonders of Galápagos: new passions begin to take hold. Voyages are filled with exciting discoveries that spark curiosity and conversation, from wild encounters with giant tortoises to impromptu courtship dances by blue-footed boobies. Moments like these are especially meaningful when complemented by the learning opportunities in the National Geographic Global Explorers program.



Developed in conjunction with National Geographic Education, this interactive program teaches kids and teens 18 and under how to explore like scientists and tell the stories of the archipelago's legendary wildlife. Led by certified field educators, kids share their experiences through photographs, videos, drawings and more. With a range of activities to choose from, the program encourages young travelers to explore their own interests, whether it's marine biology, geology or photography.





PROGRAM HIGHLIGHTS

Wildlife Watching

Zip along shore in a Zodiac, then hike in search of Galápagos wildlife, like barking sea lions and marine iguanas. Snap photos with your smartphone and jot notes in your official National Geographic Global Explorers Field Notebook.

Microscopic Exploration

Drop a net over the side of your Zodiac to collect plankton, and check it under a video microscope to see how it looks and moves.

Video Shoots

Get tips from your certified photo instructor on how to create impressive slow-motion and timelapse videos, then test out your new skills in the field.

License to Explore

Learn to operate a Zodiac and earn your 'driver's license.' (Sorry adults, kids only.)

Check Your List

Head to the ship lounge to review the wildlife you saw and mark it in your notebook. Include creatures big and small—whether it's a lava lizard or a giant tortoise. Tally your points to keep track of your progress on becoming certified as a National Geographic Global Explorer.

New Friends and Fun Adventures

Meet up with your new friends for fun activities with your certified field educator. Depending on the day, it might be a pizza dinner, games in the lounge, a special hike or other surprises.



Eyes to the Night Sky

Head to the top deck to watch the stars come out as the sun goes down. Find and record constellations with the help of your certified field educators.



Inspire Their Inner Explorer:

Visit expeditions.com/globalexplorers for program details.

THE GALÁPAGOS ISLANDS



ISABELA

Raise a glass of Ecuadorian wine as you cross the Equator in sight of Volcán Ecuador, a collapsed caldera that harbors penguins and fur seals. Watch for whales and dolphins in these rich waters, once the haunt of whalers and pirates.



SANTIAGO

Explore tide pools and search for recently reintroduced land and marine iguanas on this island where a coastal forest and spectacular geological formations are high points.

FERNANDINA

An oceanic volcano most recently active in 2022, it offers opportunities to walk across lava flows and snorkel with marine iguanas and sea turtles.



FLOREANA

Follow a trail along a rose-pink lagoon frequented by flamingos. Visit Post Office Bay, founded by 18th-century whalers, and snorkel in neighboring waters with enormous schools of tropical fish.





GENOVESA

Sail to the remote northern realm of the Galápagos, a seabird paradise bathed in warm tropical waters.



BARTOLOMÉ

Climb to the summit of this volcanic wonderland, then snorkel and swim with penguins from a golden beach.

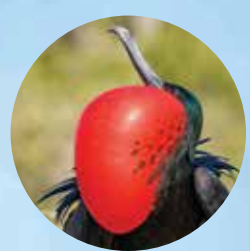

NORTH SEYMOUR

Encounter nesting frigatebirds, blue-footed boobies and land and marine iguanas, and enjoy a beautiful coastal walk.



SOUTH PLAZA

Sea lions greet us at South Plaza, an uplifted volcanic block carpeted in salt-loving succulents and teeming with wildlife, including a unique species of land Iguana.

SAN CRISTÓBAL

Search for red-footed boobies and the endemic mockingbird and lava lizard—found only on this easternmost island. Explore Baquerizo Moreno, where sea lion colonies thrive in the middle of town.



SANTA CRUZ

Meet with Galapagueños on the archipelago's most populated island. Visit the Charles Darwin Research Station and explore lush highlands where giant tortoises roam.



RÁBIDA

Snorkel along the rocky coastline among schools of tropical fish and curious sea lions before landing on a brilliant red beach to look for both land and sea birds.

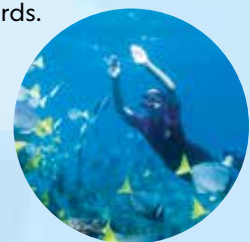

ESPAÑOLA

The oldest Galápagos island, this is a haven for endemic species and many types of birds, including Española mockingbirds, Nazca boobies and, seasonally, the world's only population of waved albatrosses.



Exploring Galápagos



10 DAYS | FROM \$6,605pp

2025-2027: Weekly expeditions year-round, departing Fridays

National Geographic Endeavour II, National Geographic Gemini

Visit expeditions.com/sailgala for itinerary detail, extensions and current rates

HIGHLIGHTS

- Walk among wildlife unfazed by your presence. Linger on beaches with sea lions, marvel at huge colonies of marine iguanas and see nesting seabirds.
- Snorkel with sea lions, turtles and abundant fish in the protected waters of the Galápagos Marine Reserve.
- Adventure by kayak, paddleboard, glass-bottom boat and Zodiac.
- Observe giant Galápagos tortoises in the wild on an excursion in the highlands of Santa Cruz.
- Explore alongside a National Geographic photographer on dedicated photography departures, and join an optional pre-voyage photo extension to the picturesque Ecuadorian Amazon.
- Extend your expedition, with options to explore colonial Quito, the tropical Andean forests of the award-winning Mashpi Lodge and more.



Special Offers

Book by Mar. 4, 2025:

- Cabin credit up to \$1,000 per guest.
- Solo savings up to 40%.
- Up to 10% savings if paid in full.

On select departures only. See page 34 or visit expeditions.com/giftofexploration for details, terms and conditions.

National Geographic Endeavour II and Kicker Rock.





Kayakers observe a blue-footed booby perched on a volcanic shoreline.

Galápagos by Catamaran: An Intimate Voyage



10 DAYS | FROM \$9,940pp

2025–2027: Weekly expeditions year-round, departing Fridays

National Geographic Delfina

Visit expeditions.com/galavoyage for itinerary details, extensions and current rates

HIGHLIGHTS

- Encounter Galápagos wildlife up close on an exclusive catamaran with 16 guests and two veteran expedition staff to guide you over a full week in the islands.
- Adventure by kayak, paddleboard and Zodiac across waters rich in marine life.
- Discover wildlife unfazed by your presence: lounge on beaches with sea lions, walk among huge colonies of marine iguanas and delight at the antics of nesting seabirds from ship and shore.
- Extend your expedition in Ecuador with a stay in Quito, or venture to Mashpi Lodge in the tropical Andes.

MORE TO EXPLORE: Discover the culture and history of Peru on the 16-day *Galápagos by Catamaran, Machu Picchu and Peru's Land of the Inca*. Visit expeditions.com/galaperuvoyage for itinerary details.



Special Offers

Book by Mar. 4, 2025:

- Cabin credit of \$1,000 per guest.
- Solo savings of 40%.
- 10% savings if paid in full.

On select departures only. See page 34 or visit expeditions.com/giftofexploration for details, terms and conditions.

Galápagos Escape: A 7- or 8-Day Voyage



7 or 8 DAYS | FROM \$6,864pp

2025-2027: Expeditions year-round, departing Thursdays
and Saturdays

National Geographic Islander II

Visit expeditions.com/wildgala7 or expeditions.com/wildgala8 for itinerary details, extensions and current rates

HIGHLIGHTS

- Travel aboard an expedition ship that feels like a private yacht, with only 26 staterooms and suites.
- Maximize your time in the islands with multiple exploration options every day.
- Snorkel and kayak in rich waters among shimmering fish, sea turtles, penguins and playful sea lions.
- Walk among wildlife colonies unfazed by your presence.
- Relax at Hotel Del Parque, a serene tropical refuge and Relais & Chateaux property along the banks of the river in Guayaquil. Or opt for Casa Gangotena in the heart of Quito. Additional nights are available for further exploration.
- Extend your expedition at the famed Otavalo market.



Special Offers

Book by Mar. 4, 2025:

- Cabin credit of \$500 per guest.
- Solo savings of 40%.
- 10% savings if paid in full.

On select departures only. See page 34 or visit expeditions.com/giftofexploration for details, terms and conditions.

Sea lion, Galápagos.





Machu Picchu, Peru.

Peru and Galápagos Escape



11 or 12 DAYS | FROM \$8,986pp
 2025-2027: Expeditions year-round, departing Fridays
National Geographic Islander II

Visit expeditions.com/wildgalaperu for itinerary details, extensions and current rates

HIGHLIGHTS

- Experience two iconic destinations in one fast-paced and active expedition.
- Linger into the late afternoon at fabled Machu Picchu, introduced to the world by Hiram Bingham in the April 1913 issue of *National Geographic Magazine*.
- Spend two nights in the Sacred Valley of the Inca and a night in Cusco, imperial capital of the Inca.
- Maximize your time in Galápagos with multiple exploration options every day.
- Sail into a flooded caldera and visit a birdwatcher's paradise.
- Extend your expedition in vibrant, cosmopolitan Lima or in UNESCO-designated Quito and the famed Otavalo market.

NEW! Beginning in 2026, this voyage has an additional night in Cusco, the capital of the Inca empire.



Special Offers

Book by Mar. 4, 2025:

- Cabin credit of \$1,000 per guest.
- Solo savings of 40%.
- 10% savings if paid in full.

On select departures only. See page 34 or visit expeditions.com/giftofexploration for details, terms and conditions.

COMBINE AND SAVE

Make the most of your time in the region by combining your Galápagos experience with other immersive journeys on the mainland. Or stay in the Galápagos for back-to-back departures of your voyage, enjoying an extended experience that allows you to see even more of this fascinating archipelago. When you book consecutive expeditions—whether it's two, three or more departures—you save 10% on each.



Add Machu Picchu and Peru's Land of the Inca

16 days | Land program + Galápagos aboard *National Geographic Gemini*, *National Geographic Delfina* or *National Geographic Endeavour II*
From: \$12,643pp

After your Galápagos voyage, journey from Cusco to fabled Machu Picchu, encountering archaeological relics of the Inca and vibrant cultures of the Andes. Explore three UNESCO World Heritage sites—capital city Lima, colonial Cusco and Machu Picchu—and watch a weaving demonstration with a National Geographic Grantee who has kept Andean textile traditions alive.



Machu Picchu.

Add Upper Amazon: A River Expedition

18 Days | Amazon + Galápagos aboard *National Geographic Gemini*, *National Geographic Delfina* or *National Geographic Endeavour II*
From: \$14,487pp

Combine your Galápagos expedition with a voyage on the Upper Amazon aboard the elegant *Delfin II*. Glide into narrow tributaries by skiff and kayak for a closer look at unusual plants and wildlife, from monkeys and macaws to pink dolphins. You'll also visit local communities along the river that National Geographic-Lindblad Expeditions supports in collaboration with Minga Peru.



Delfin II at sunset.

Back-To-Back Galápagos Voyages

Book consecutive departures of any Galápagos voyage to explore even more of the archipelago. Following Galápagos National Park regulations, ships cannot visit an individual site more than once every two weeks; the fleet operates a 14-night schedule with new sites every day, an initiative aimed at spreading visitors across the archipelago for a more intimate experience.



Guests embark on a Zodiac ride in Galápagos.

EXPLORE MORE OF YOUR DESTINATION

Expedition extensions around the Galápagos offer a more complete picture of your destination, bringing you beyond the shoreline to explore the intricate ties between land and sea. Traveling under the care of National Geographic-Lindblad Expeditions, alongside local experts with in-depth knowledge of the region, you'll enjoy an illuminating experience and seamless connections between ship and shore. Make the most of your next expedition with one of these pre- or post-voyage extensions.



See Quito

Pre-Voyage | Exploring Galápagos and Galápagos Escape

3 Days | From \$449pp

From your base at the Swissôtel Quito, experience this vibrant city—the world’s first UNESCO World Heritage site—with its dazzling colonial churches and bustling traditional markets. Focus your explorations on the Centro Histórico, where a colonial legacy blends with contemporary Andean culture. This extension adds just one night to your voyage, giving you time to get acclimated to Ecuador before your expedition.



Tropical Andes and Colonial Quito

Pre-Voyage | Exploring Galápagos

6 Days | From \$2,690pp

After touring Quito’s enchanting UNESCO World Heritage-listed colonial center, enjoy time to explore on your own from your base at Casa Gangotena, a restored Art Deco mansion and Relais & Châteaux property. Then immerse yourself in the Ecuadorian Chocó—one of the world’s top biodiversity hotspots—during a stay at the exquisite Mashpi Lodge, set amid a tropical forest thrumming with life.



Quito and Otavalo

Post-Voyage | Galápagos Escape and Peru and Galápagos Escape
4 Days | From \$1,150pp

Explore Ecuador's beautifully preserved colonial capital from Casa Gangotena, part of the prestigious Relais & Châteaux hotel collection. Then venture to Otavalo in the Andean Highlands and stroll this mountain town's celebrated handicraft markets at your own pace, browsing stalls brimming with colorful clothing, jewelry and textiles. You'll also visit a nearby weaving village and enjoy lunch at a historical hacienda.



Plaza de Armas and the Lima Cathedral in the historic center of Lima.

Taste of Lima

Pre-Voyage | Peru and Galápagos Escape
3 Days | From \$470pp

Discover vibrant, cosmopolitan Lima on this pre-voyage extension, featuring two nights at the classic Lima Country Club Hotel in fashionable San Isidro. Explore the UNESCO-designated heart of the colonial center; admire the remarkable Museo Larco, housing one of the world's largest collections of Pre-Columbian art; and sample the city's celebrated cuisine.





Sunrise over the Ecuadorian Amazon.

Ecuador's Amazon: Yasuní Wildlife Photo Extension

Pre-Voyage | Exploring Galápagos
7 Days | From \$3,329pp

On dedicated photo departures of the fleet's weeklong Galápagos expedition, guests have the option to join a photography-focused extension in the Ecuadorian Amazon. Venture to Yasuní National Park, one of the most biodiverse places on the planet, and hone your camera skills alongside a National Geographic photographer while capturing images of colorful birds, blooming flora and much more.



Guests approach the Wildlife Center Ecolodge in Yasuní National Park by dugout canoe.

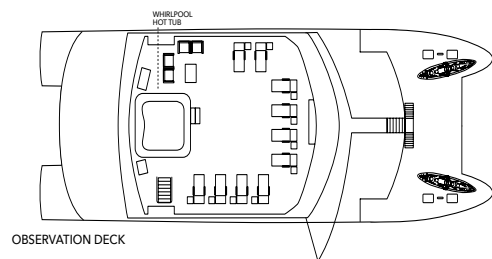

OBSERVATION DECK

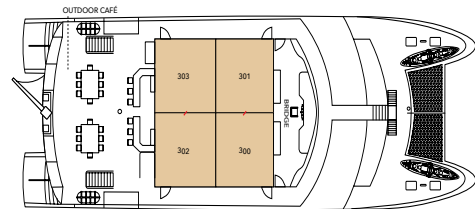

UPPER DECK

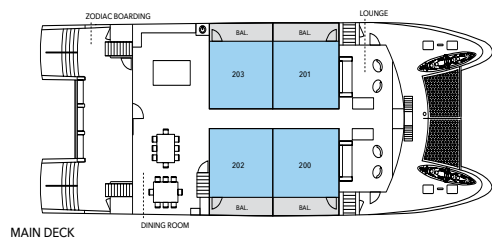

MAIN DECK

/ indicates adjoining staterooms

Clockwise from top: National Geographic Delfina; Category 4 stateroom; outdoor café.

National Geographic Delfina

CAPACITY: 16 guests in 8 staterooms.

REGISTRY: Ecuador. **OVERALL LENGTH:** 98 feet.

PUBLIC SPACES: The open-air observation deck provides 360-degree views and features a Whirlpool hot tub and lounge chairs to take in your surroundings. On the wrap-around upper deck, dine al fresco at the stern and enjoy spectacular island views from the bow. The outdoor café accommodates all guests in a single unassigned seating. The lounge on the main deck hosts presentations and recaps. Zodiac boarding and gearing up area for snorkeling and excursions are also located on the main deck.

MEALS: Indoor-outdoor dining with Ecuadorian flair served in a single, unassigned seating in the outdoor café and dining room. The atmosphere is sociable and informal, and menus feature local, sustainable ingredients.

ACCOMMODATIONS: 16 guests accommodated in 8 staterooms on two decks. Category 4 staterooms can be reserved as interconnected, starboard and port. Category 5 staterooms have a private balcony. All accommodations are bright with outside views, convertible queen/twin beds, ample closets and large bathroom with plush bathrobes and stand-up showers. In addition, staterooms have a stocked mini-bar and a flat-screen TV.

EXPEDITION TOOLS: Zodiacs for landings and cruising, a fleet of kayaks and stand-up paddleboards, snorkel gear for adults and children.

SEE MORE ONLINE: Learn more about *National Geographic Delfina* at expeditions.com/delfina

SPECIAL FEATURES: Two veteran National Geographic-Lindblad Expeditions staff: an expedition leader and National Geographic certified photo instructor, both licensed naturalists. Staff are certified as field educators to offer the National Geographic Global Explorers program for kids and teens. Snorkel or kayak instruction, Wi-Fi access. Note: This vessel does not carry a medical professional. Please call with questions.

CATEGORY 4: Upper Deck— 172 sq.ft. with large window, convertible queen/twin beds, desk, ample closets, and large bathroom with plush bathrobes and stand-up showers #300, 302, 301, 303

CATEGORY 5: Main Deck— 172 sq.ft. with two large windows, private balcony, convertible queen/twin beds, desk, ample closets and large bathroom with plush bathrobes and stand-up showers #200, 202, 201, 203

CONNECTING STATEROOMS: #300/301, 302/303

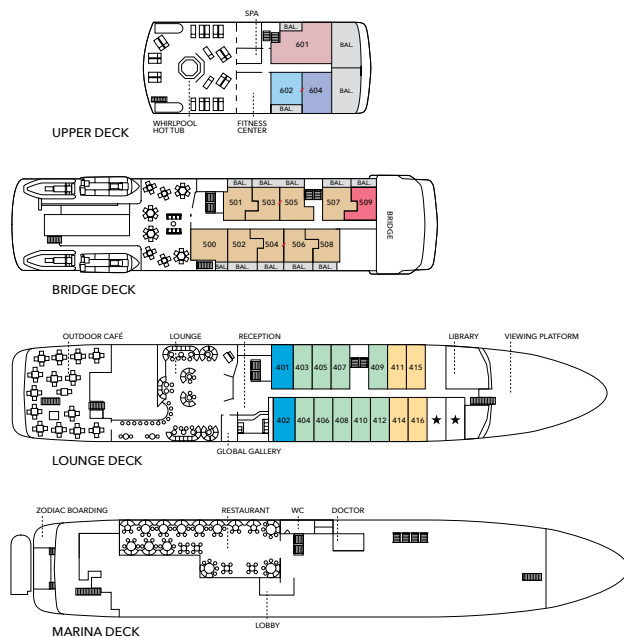

Clockwise from top: National Geographic Gemini; Category 6 stateroom; upper deck with Whirlpool hot tub.

/ indicates adjoining cabins

National Geographic Gemini

CAPACITY: 48 guests in 28 outside cabins.

REGISTRY: Ecuador. **OVERALL LENGTH:** 296 feet.

PUBLIC AREAS: The upper deck features an outdoor shower, Whirlpool hot tub with adjacent shaded seating area and a windowed fitness center and spa that is perfect for relaxing. The outdoor café accommodates all guests in a single seating, and the expansive lounge hosts presentations and recaps, and features a well-stocked comfortable bar; Global Gallery; and reception, all located on the lounge deck. Zodiac boarding and gearing up area for snorkeling and excursions and the dining room with flexible seating for everyone are located on the marina deck.

MEALS: Served in a single, unassigned seating in a sociable, informal atmosphere with Ecuadorian flair in the dining room and outdoor café.

CABINS: All face outside with large windows and feature single beds that convert to a queen, with private facilities and climate control, night-stands, desk and storage. Three sets of cabins with a connecting door. Thirteen cabins have private balconies, including two suites with large private balconies.

EXPEDITION EQUIPMENT: Zodiacs, glass-bottom boat, kayaks and stand-up paddleboards, snorkel gear and wetsuits for both adults and children, video microscope and underwater video camera.

SPECIAL FEATURES: National Geographic certified photo instructor, shipboard doctor, National Geographic Global Explorers family program, snorkel and kayak instruction, Wi-Fi access, laundry service, Global Gallery.

WELLNESS: LEXSpa and fitness center, exercise classes and wellness specialist.

SEE MORE ONLINE: Learn more about *National Geographic Gemini* at expeditions.com/gemini

CATEGORY 1: Lounge Deck #411, 414, 415, 416 Forward cabins, outside facing with a large window.

CATEGORY 2: Lounge Deck #403-408, 409, 410, 412 Outside facing with a large window.

CATEGORY 4: Bridge Deck #500-508 Outside facing with floor-to-ceiling glass doors, 50-square-foot balcony with seating.

CATEGORY 5: Upper Deck #602 Outside facing with floor-to-ceiling glass doors, 50-square-foot balcony with seating.

CATEGORY 6: Upper Deck #604 Forward facing with floor-to-ceiling glass doors, 195-square-foot forward-facing balcony with seating.

CATEGORY 7: Upper Deck #601 Forward facing suite with separate living room, large bathrooms, with floor-to-ceiling glass doors and 195-square-foot forward-facing balcony with seating. Bedroom with 50-square-foot side balcony.

CATEGORY 2 SOLO: Lounge Deck #401 and 402 Outside facing with a large window.

CATEGORY 5 SOLO: Bridge Deck #509 Outside facing with floor-to-ceiling glass doors, 50-square-foot balcony with seating.

CONNECTING CABINS: #504/506, 503/505, 602/604

TRIPLE OCCUPANCY: #500, 503, 601, 604.

SHARED ACCOMMODATIONS: Shares can be arranged at the double occupancy rate in Category 1.

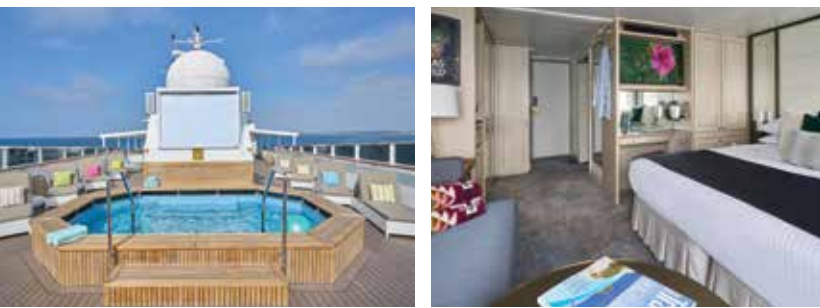

Clockwise from top: National Geographic Islander II; spacious Category SU stateroom; plunge pool.

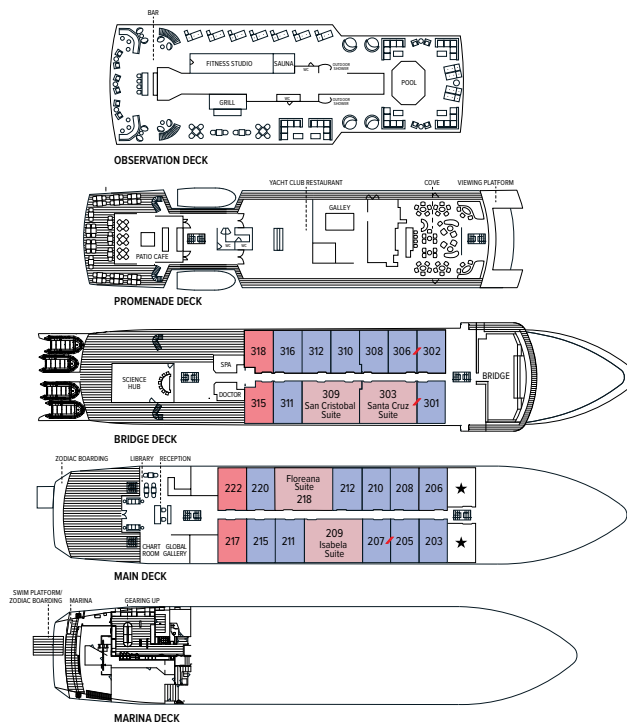

∕ indicates adjoining staterooms and suites

National Geographic Islander II

CAPACITY: 48 guests in 26 staterooms and suites.
REGISTRY: Ecuador. **OVERALL LENGTH:** 280 feet.

This all-suite vessel, newly refitted for Galápagos, launched in August 2022.

PUBLIC SPACES: Expansive observation deck with grill and bar, fitness center, sauna, outdoor showers and plunge pool; indoor-outdoor patio café and indoor Yacht Club restaurant; lounge newly outfitted for state-of-the-art presentations for all guests, with full-service bar; forward viewing platforms and expansive surrounding teak decks throughout the ship; Science Hub with interactive video display, onboard television network, photo kiosks and versatile lab facilities; reception, chart room, Global Gallery, library and beverage center. Newly expanded marina with gearing up and snorkel areas, Zodiac boarding, and swim platform.

MEALS: Indoor-outdoor dining with Ecuadorian flair served in a single, unassigned seating in the Patio Café and Yacht Club. The atmosphere is sociable and informal, and menus feature local, sustainable ingredients.

ALL SUITES: 48 guests accommodated in 26 staterooms and suites spread across two decks with connecting, solo and triple options; four Islander Suites with separate living area, table and chairs and bath with bathtub. The Santa Cruz Suite can be reserved as a Family Suite with connecting double suite. All accommodations have large windows, convertible king/twin beds, ample closets, marble double-sink bathrooms, Wi-Fi access, stocked mini-bar, flat screen television with shipboard network.

EXPEDITION TOOLS: Zodiac Mark V boats for landings and cruising, custom-built glass-bottom Zodiac, fleet of kayaks and stand-up paddleboards, snorkel gear for adults and children, Science Hub equipped for oceanography, video editing and screenings, video microscope, remote cameras.

SPECIAL FEATURES: Shipboard doctor, undersea specialist, National Geographic certified photo instructor, National Geographic Global Explorers family program led by National Geographic certified field educators, suites for science and conservation (indicated as ★ on deck plan) reserved for invited Galápagos community members, researchers, educators, and storytellers.

WELLNESS: Wellness specialist, fitness center, yoga space, spa with quartz massage table, sauna.

STATEROOM: Bridge & Main Deck—280 sq. ft. with two large windows, seating area with sofa, lounge chair #203-207, 211, 215, 206-208, 210-212, 220, 301, 311, 302, 306-308, 310-312, 316

ISLANDER SUITE: Bridge & Main Deck—515 sq. ft. with four windows, separate living room with sofa, two lounge chairs, large bath with rain shower and tub #209, 218, 303, 309

SOLO STATEROOM: Bridge & Main Deck—280 sq. ft. with two large windows, seating area with sofa, lounge chair #217, 222, 315, 318

CONNECTING STATEROOMS: #205/207, 302/306

FAMILY SUITE: Santa Cruz Islander Suite #303/301

TRIPLE OCCUPANCY: Staterooms #312, 316, and Islander Suites (#209, 218, 303, 309). With sofa made up as third bed. Third person rates are one-half the double occupancy rate.

SHARED OCCUPANCY: Shares can be requested for staterooms at double occupancy rate.

SEE MORE ONLINE: Learn more about *National Geographic Islander II* at expeditions.com/islanderii



OBSERVATION DECK

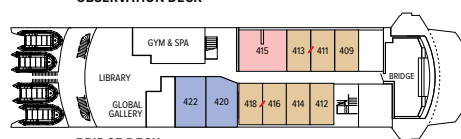

BRIDGE DECK

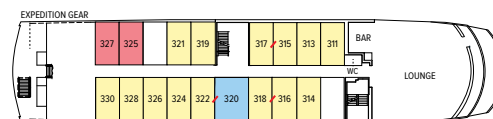

LOUNGE DECK

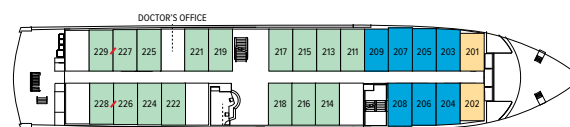

UPPER DECK

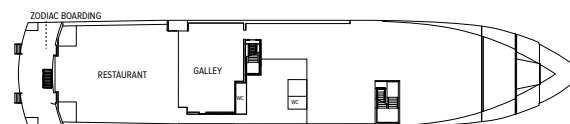

MAIN DECK

↗ indicates adjoining cabins

Clockwise from top: National Geographic Endeavour II features 52 cabins accommodating 96 guests; Category 1 cabin; dining room.

National Geographic Endeavour II

CAPACITY: 96 guests in 52 outside cabins.

REGISTRY: Ecuador. **OVERALL LENGTH:** 236 feet.

PUBLIC AREAS: Forward lounge and bar accommodating all guests for presentations and gatherings, restaurant, large library with Mac kiosks, open-air observation deck, underwater gear area and dual Zodiac boarding platform and “open Bridge,” where guests can meet the captain and officers and learn about navigation.

MEALS: Served in a single, unassigned seating in a sociable, informal atmosphere with Ecuadorian flair.

CABINS: All face outside with large windows and feature single beds that convert to a queen. With private facilities and climate control, nightstands, desk and storage. Seven sets of cabins with a connecting door.

EXPEDITION EQUIPMENT: Zodiacs, glass-bottom boat, kayaks and paddleboards, snorkel gear and wetsuits for both adults and children, video microscope and underwater video camera.

SPECIAL FEATURES: National Geographic certified photo instructor, shipboard doctor, National Geographic Global Explorers family program, snorkel instruction, Wi-Fi access, laundry service, Global Gallery.

WELLNESS: LEXSpa and fitness center, exercise classes, and wellness specialist.

CATEGORY 1: Upper Deck, #201, 202 Cabins face outside with a large window.

CATEGORY 2: Upper Deck #211, 213-219, 221, 222, 224-229 Cabins face outside with a large window.

CATEGORY 3: Lounge Deck #311, 313-319, 321, 322, 324, 326, 328, 330 Cabins face outside with a large window.

CATEGORY 4: Bridge Deck #409, 411-414, 416, 418 Cabins face outside with a large window.

SUITE A: Lounge Deck, Mid-Ship #320 Suites face outside with two windows, larger bath, double closet. Connecting door to #322.

SUITE B: Bridge Deck, Mid-Ship #420, 422 Suites face outside with two floor-to-ceiling windows, larger bath, double closet and convertible sofa for a third person.

SUITE C: Bridge Deck, Mid-Ship #415 Suites face outside with two large windows, larger bath, separate sitting area with convertible sofa for a third person and lounge chair, coffee table and extra closet space.

CATEGORY 2 SOLO: Upper Deck #203-209 Cabins face outside with a large window.

CATEGORY 3 SOLO: Lounge Deck #325, 327 Cabins face outside with a large window.

CONNECTING CABINS: #226/228, 227/229, 315/317, 316/318, 320/322, 411/413, 416/418

TRIPLE OCCUPANCY: #224, 225, 326, 328 with fold-down upper third bunk, Suites B and C with convertible sofa bed. Third person rates are one-half per person double occupancy rate.

SHARED ACCOMMODATIONS: Shares can be arranged at the double occupancy rate in Categories 1 and 2.

SEE MORE ONLINE: Learn more about *National Geographic Endeavour II* at expeditions.com/endeavourii

THE GALÁPAGOS FLEET AT A GLANCE A GLANCE



National Geographic Delfina

Launches Feb. 2025

Guest Capacity

16

Cabins

8

Solo Cabins

0

Connecting Cabins

4

Balcony Cabins

4

Spa Facilities

0

Fitness Center

0

Diving Options

0

Exclusive Family Program

1

Bar Tab and Wi-Fi Included

1

Itinerary and Duration

Galápagos by Catamaran:
An Intimate Voyage (10 day),
Galápagos by Catamaran, Machu Picchu
and Peru's Land of the Inca (16 day)

Extensions

Tropical Andes and Colonial Quito Pre-Voyage, See Quito Pre-Voyage



National Geographic Gemini

Launches Mar. 2025

48

28

3

6

13

1

1

0

1

1

Exploring Galápagos (10 day), Exploring Galápagos, Machu Picchu and Peru's Land of the Inca (16 day)

Tropical Andes and Colonial Quito Pre-Voyage, See Quito Pre-Voyage



National Geographic Islander II

Launched 2022

48

26

4

6



Galápagos Escape: A 7- or 8-Day Voyage, Peru and Galápagos Escape (12 and 11 day)

Quito and Otavalo Post-Voyage, See Quito Pre-Voyage, Taste of Lima Pre-Voyage



National Geographic Endeavour II

Refurbished 2016

96

52

9

14



Exploring Galápagos: (10 day), Exploring Galápagos, Machu Picchu and Peru's Land of the Inca (16 day)

Tropical Andes and Colonial Quito Pre-Voyage, See Quito Pre-Voyage, Ecuador's Amazon: Yasuní Wildlife Photo Pre-Voyage

All ships include

Photography Program

Open Bridge

World Class Expedition Team

Excursions

Tools for Exploration

Undersea Specialist*

Meals and Beverages

Medical Professional*

Family Friendly

Free of guest-facing single-use plastic

*National Geographic Delfina does not carry an undersea specialist nor a medical professional. Please call for details.

GIFT OF EXPLORATIONS OFFER

Gift Of Exploration: Book By Mar. 4, 2025

Valid for new bookings only on select departures, subject to availability, not applicable on airfare or extensions and may not be combined with other offers.

Up To \$2,000 Credit: Book from December 3, 2024 to March 4, 2025. Receive a credit up to \$2,000 per person, deducted from cabin fare prior to any additional applicable savings with the purchase of cabin fare. Receive a credit of \$500 per person for expeditions of 8 days or less. Receive a credit of \$1,000 per person for expeditions of 9 to 14 days. Receive a credit of \$2,000 per person for expeditions of 15 days or more.

Solo Savings Up To 40% Off: Book from December 3, 2024 to March 4, 2025. Save 25%, 33% or 40% on solo cabins on select departures.

- 25% solo savings based on select departures of *Galápagos by Catamaran, Machu Picchu and Peru's Land of the Inca* aboard *National Geographic Delfina*

- 33% solo savings based on select departures *Exploring Galápagos* aboard *National Geographic Endeavour II*
- 40% solo savings based on select departures of *Galápagos by Catamaran: An Intimate Voyage* aboard *National Geographic Delfina*

Solo savings are subject to availability. Other expeditions may be available for solo savings. A full list of solo savings is available via expeditions.com; or call for details.

Additional Up To 10% Savings When You Pay in Full:

Book from December 3, 2024 to March 4, 2025. Save an additional up to 10% on the cabin fare when you pay in full at time of booking. 10% saving is available on select Antarctica and Galápagos departures. Other applicable departures are at 5% savings. To qualify for the discount, non-refundable payment in full is due at the time of booking. Call for details.

INCLUSIVE PRICING

- Excursions, hotels and airport transfers as indicated in the itinerary
- All meals as indicated in the itinerary, both aboard and on shore. Meals are inspired by regional cuisine and locally sourced where possible.
- Hors d'oeuvres inspired by regional cuisine and locally sourced
- 24-hour access to snacks, premium coffees and teas, non-alcoholic beverages and filtered water
- Beer, wine, cocktails and spirits
- Selection of exploration tools curated to your destination, such as Zodiacs and glass-bottom boats, stand-up paddleboards, kayaks, snorkeling equipment (including wetsuits, masks, and fins)
- Guidance and company of leading expedition staff
- Presentations on your destination by expedition staff and expert guest speakers
- The services of a physician, where available
- Morning stretch classes and 24-hour access to exercise equipment, where available
- 24-hour access to lounges, observation decks, library stocked with regionally relevant literature, and other shared spaces
- Complimentary reusable water bottle to fill at onboard water refill stations
- Park and site entrance fees, special access permits, and port taxes

NEW! COMPLIMENTARY WI-FI

We are pleased to offer wireless internet across the expedition fleet through a partnership with Starlink, the world's first and largest satellite constellation. Starlink's low-latency, highspeed internet provides a strong, fast signal in remote destinations, whether you're sailing along the shores of Antarctica or through the middle of the Pacific Ocean. Enjoy a complimentary basic Wi-Fi plan aboard the National Geographic-Lindblad Expeditions fleet that accommodates email, messaging and social media apps. Upgrades are also available:

- Enhanced Wi-Fi plan: accommodates web browsing, video conferencing and other functions that require increased bandwidth. Available for purchase at \$25 per day or \$150 for the entire voyage.
- Premium Wi-Fi plan: accommodates most internet needs, including video streaming and uploading and sending large files. Available for purchase at \$50 per day or \$300 for the entire voyage.



PRIVATE CHARTER

Charter with National Geographic-Lindblad Expedition and sail to the heart of the world's most remote and wild places—with your favorite travel companions. Host your next board meeting or an incentive trip for your employees, or gather your friends and family for a special celebration in the Galápagos. When you charter one of our intimate expedition ships exclusively for your group, the team will customize every detail of your experience to ensure your time on board is unforgettable. Discover the wild world on your private voyage with National Geographic-Lindblad Expedition and cherish the memories forever. For more information, contact:

Karen Kuttner-Dimitry

Vice President of Affinity & Charter Sales

908-295-3810

karenk@expeditions.com

LOG ON TO EXPEDITIONS.COM

Find everything you need to dream, research or plan travel to 110+ destinations worldwide.

- Subscribe to the email newsletter
- See expeditions.com/stories for articles, videos & Daily Expedition Reports
- Follow the social media pages for great posts @lindbladexp on Instagram, Pinterest and X, and @lindbladexpeditions on Facebook
- Subscribe to videos on [Youtube.com/lindbladexpeditions](https://www.youtube.com/lindbladexpeditions)



RESERVATION INFORMATION

Terms & Conditions: For complete terms and conditions please visit expeditions.com/terms. For best pricing book early. Prices quoted in this brochure are per person based on double occupancy in USD, and based on select departures. Prices quoted are valid at the time of printing, December 17, 2024, are subject to change and availability at time of booking, and are not guaranteed until required deposit is made. Visit expeditions.com or call for all pricing.

Pricing Includes: All accommodations aboard ship or in hotels per itinerary; transfers, regardless of flight or arrival/departure day, with included services; all meals as indicated in the itinerary, both aboard and onshore; beer, wine, and spirits aboard the ship (except certain super premium brands, which are available for purchase); hors d'oeuvres, 24-hour access to snacks, premium coffees and teas, non-alcoholic beverages and filtered water; excursions and airport transfers to and from recommended flights, as indicated in the itinerary; gratuities in Guayaquil, Quito and Peru to local guides, drivers and tour escort; exploration tools curated to destination, such as Zodiacs, stand-up paddleboards, kayaks, snorkeling equipment (including wetsuits, masks, and fins); guidance and company of leading expedition staff; assistance by the National Geographic certified photo instructor; presentations by expedition staff and expert guest speakers; basic Wi-Fi; complimentary reusable water bottle; services of a physician, where available; morning stretch classes and 24-hour access to exercise equipment, where available; 24-hour access to lounge, observation decks, library and other shared spaces; park and site entrance fees, special access permits and port taxes. Unused services or items included in our programs are non-refundable.

Not Included: Airfare; pre- and post-expedition extensions; additional hotel nights (except when indicated as included); crew gratuities; laundry, spa treatments, scuba diving and phone services; travel protection plans; and passport, visa and immigration fees.

Airfare: For all programs, airfare is an additional cost. National Geographic-Lindblad Expeditions will gladly assist in making your air arrangements for a \$50 per person service fee.

Reservations, Deposits and Final Payments: To reserve your place, an advance payment deposit is required at the time of reservation. Receipt of advance payment deposit indicates your acceptance of the terms and conditions. Final payment schedule can be found online. Visit expeditions.com/terms for complete details about deposits and final payment schedules, which may vary by ship.

Travel Protection Plan: It is strongly recommended that you take advantage of the Travel Protection Plan. This plan offers comprehensive coverage to protect you from cancellation fees, costs incurred due to trip delays/interruption, medical assistance and damaged or lost baggage, and provides medical assistance and evacuation during your travels. The Travel Protection Plan is available for U.S. residents only and may be purchased any time prior to final payment due date. If you are not satisfied for any reason, you may return your plan within 10 days after purchase. Your premium will be refunded if canceled within 10 days, provided you have not already departed on the trip or filed a claim. When so returned, the coverage under the plan is void from the original date of purchase.

Responsibility and Other Terms & Conditions: Certain provisions concerning, among other things, limitations of Lindblad Expeditions' and National Geographic Expeditions' (a division of National Geographic Partners, LLC) liability for loss of property, injury, illness or death during the voyage will be provided to all guests on the ship's ticket sent prior to departure, and are also available on the website at expeditions.com/terms, or upon request. By registering for a trip, the guest agrees to all such terms and conditions.

Cancellation Policy: Call for details or visit expeditions.com/cancellation-policy

Lindblad Expeditions, LLC is a registered member of the CA Seller of Travel Program #2151120. Registration as a seller of travel does not constitute approval by the State of California.

©2024 Lindblad Expeditions. All Rights Reserved. Lindblad Expeditions and the Eye are the trademarks of Lindblad Expeditions, LLC.

©2024 NATIONAL GEOGRAPHIC EXPEDITIONS and the Yellow Border Design are trademarks of the National Geographic Society, under license.

Photo Credits: imageBROKER / Alamy, Jonathan Aguas, Alexandra Daley-Clark, Joshua Vela Fonseca, Kyle Furey, Ralph Lee Hopkins, Getty Images/iStockphoto, Perrin James, Sven-Olof Lindblad, Jeff Litton, Rich Reid, Marco Ricca, Tom Ritchie, Daniel Romagosa, Emily Mount, Michael S. Nolan, Jose R. Calvo Samayoa, Douglas Scaletta, Shutterstock, Boris Stroujko/Shutterstock, True Touch Lifestyle/Shutterstock, David Vargas.

For Reservations: Contact your travel advisor or call 1.877.689.1962 or 212.261.9000

Reservation Hours: Monday – Friday 9am – 8pm ET

Saturday & Sunday 10am – 5pm ET

Lindblad Expeditions, Inc.,

96 Morton Street, New York, NY 10014

For additional information and online reservations, visit expeditions.com

National Geographic-Lindblad Expeditions
96 Morton Street, New York, NY 10014

Account Number:



1.877.689.1962 | WWW.EXPEDITIONS.COM

©2024. Travel + Leisure® is a registered trademark of Travel + Leisure Holdco, LLC, a subsidiary of Wyndham Destinations, Inc. Travel + Leisure® World's Best Awards is used under license. Travel + Leisure® is published by TI Inc. Affluent Media Group, a Dotdash Meredith company, which is not affiliated with Wyndham Destinations, Inc. or its subsidiaries.

Pioneering Responsible Exploration: From our consistent quest to improve our practices to offsetting 100% of our carbon emissions, supporting conservation, science, and education initiatives around the planet and investing in the communities in the places we explore, we are guided by our commitment to explore responsibly.

Printed on 10% recycled content paper with soy-based inks. We recommend that you pass this along for others to enjoy or recycle.

GAL-0125

DISCOVER A WORLD OF POSSIBILITY

Take advantage of special offers designed for every type of traveler. Book select departures by March 4, 2025 to receive:

- A cabin credit of up to \$2,000 per guest
- Solo savings of up to 40%
- Up to 10% in additional savings when you pay in full at the time of booking

See pg. 34 or visit expeditions.com/giftofexploration for details, terms and conditions.



Visit expeditions.com/gala for details.

